

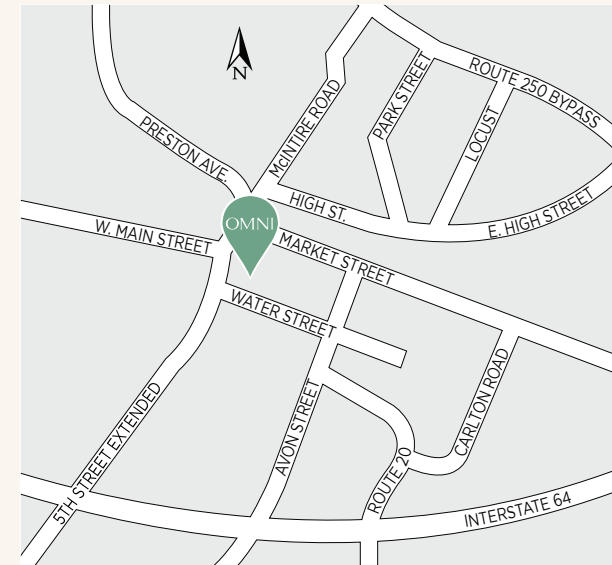

Memorable gatherings in the VIRGINIA WINE COUNTRY.

Meetings and events at the newly renovated Omni Charlottesville Hotel put you at the heart of Charlottesville Downtown Mall. With over 14,000 square feet of flexible event space, you can host anything from a conference for hundreds to a board meeting for six.

Your guests will love walking the red brick pathways of the Downtown Mall, considered one of the finest urban parks in the country. Breakfast is served at The Hillock Neighborhood Kitchen overlooking the Downtown Mall, or gather for cocktails and shareable plates at The Conservatory, our signature bar. Unwind in the whirlpool or dry sauna after the day's business is done. Nearby, explore historic sites like Monticello or visit prestigious University of Virginia to make the most of your Charlottesville event.



OMNI CHARLOTTESVILLE HOTEL
212 RIDGE MCINTIRE ROAD
CHARLOTTESVILLE, VIRGINIA 22903
434.971.5500
OMNIHOTELS.COM/CHARLOTTESVILLE

Charlottesville *highlights.*

Tucked in the Blue Ridge Mountains, Charlottesville is a haven of national history, natural beauty and creative destinations. Wander the historic Downtown Mall to browse over 120 shops and boutiques, plus restaurants, cafes and performance venues. Hop on the free downtown trolley for easy access to the University of Virginia, and sip your way through dozens of local wineries to taste the Virginia terroir.

AIRPORTS

Charlottesville Albemarle Airport (CHO) | 16 min

ATTRACTIONS

Downtown Mall | adjacent
 University of Virginia | 8 blocks
 Monticello | 10 min
 Ash Lawn Highland | 17 min
 Shenandoah National Park | 30 min

ARTS & CULTURE

Paramount Theater | 3 blocks
 McGuffey Art Center | 4 blocks
 Ix Art Park | 5 blocks
 Virginia Discovery Museum | 6 blocks
 Ting Pavilion | 7 blocks
 The Fralin Museum of Art at the University of Virginia | 12 blocks



Meetings & Event Guide.

OMNI CHARLOTTESVILLE HOTEL



EXPERIENCES MATTER HERE



OMNI
 CHARLOTTESVILLE



about
Omni Charlottesville
Hotel.

THE FRESH FACE OF SOUTHERN HOSPITALITY

Omni Charlottesville Hotel is a comfortable retreat in the heart of Charlottesville's downtown. With some rooms offering mountain or city views, your guests can make the most of this central location. Swim year-round at our indoor and outdoor pools, and burn off steam at the well-equipped fitness center.



- 205 recently renovated guest rooms that combine soothing style and contemporary luxury; some have views of the Blue Ridge Mountains or historic Charlottesville
- 14,000 square feet of flexible meeting and event space, including the 5,500 square-foot Jefferson Ballroom
- Fast Wi-Fi, the latest AV technology and helpful professional services
- Seasonal outdoor pool and indoor heated pool for year-round relaxation, plus whirlpool
- Two new signature dining destinations including The Hillock with views overlooking Downtown Mall and The Conservatory
- Fully equipped fitness studio with strength training and cardio equipment, plus dry sauna

Flexible, Next Generation Event & Meeting Space.

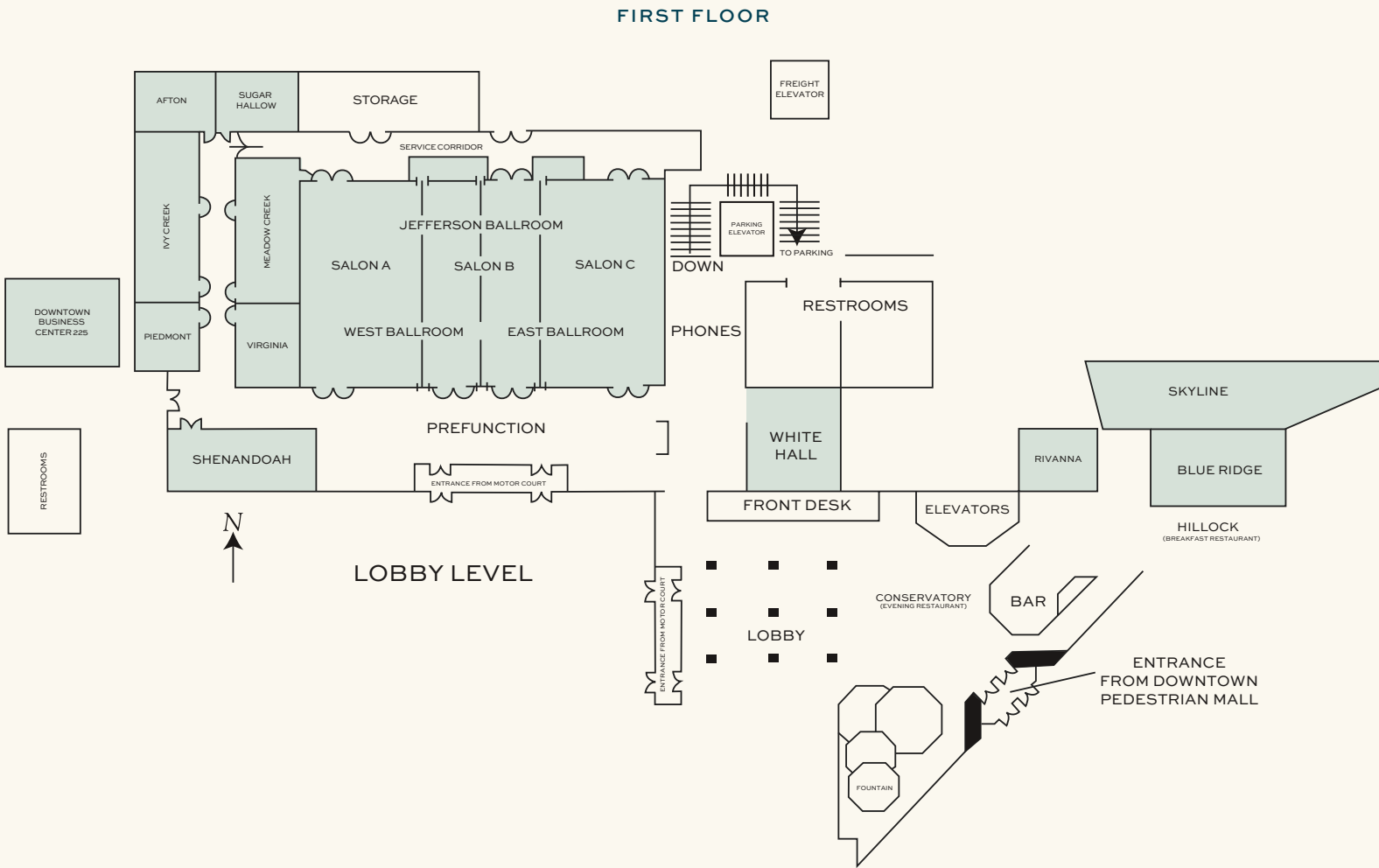

ROOM	SQUARE FOOTAGE	DIMENSIONS	WINDOWS	CEILING HEIGHT	PORTABLE WALLS	THEATER	CLASSROOM 18"	BANQUET 60"	RECEPTION	HOLLOW SQUARE	CONFERENCE
JEFFERSON BALLROOM	5,500 SQ FT	99' X 55'	NO	14'	YES	528	330	450	900	120	90
A&B/B&C	3,630 SQ FT	66' X 55'	NO	14'	YES	320	168	300	600	90	54
EAST/WEST	2,695 SQ FT	49' X 55'	NO	14'	YES	220	126	200	400	72	
A, B OR C	1,815 SQ FT	33' X 55'	NO	14'	NO	160	84	150	200	54	
SHENANDOAH	1,050 SQ FT	35' X 30'	NO	10'	NO	100	66	60	110	35	28
IVY CREEK	748 SQ FT	17' X 44'	NO	10'	NO	55	48	50	70	39	39
MEADOW CREEK	629 SQ FT	17' X 37'	NO	10'	NO	48	36	40	60	30	30
VIRGINIA	374 SQ FT	17' X 22'	NO	10'	NO	-	-	-	-	-	10
AFTON	352 SQ FT	22' X 16'	NO	10'	NO	-	-	-	-	-	10
SUGAR HOLLOW	352 SQ FT	22' X 16'	NO	10'	NO	28	21	20	30	12	12
PIEDMONT	289 SQ FT	17' X 17'	NO	10'	NO	20	15	20	28	12	12
SKYLINE	1,530 SQ FT	90' X 17'	YES	12'	NO	130	64	80	120	46	46
BLUE RIDGE	675 SQ FT	33' X 20'	NO	12'	NO	60	30	50	65	18	22
RIVANNA	432 SQ FT	24' X 18'	NO	12'	NO	35	15	30	40	12	16
WHITE HALL	248 SQ FT	15.5' X 16'	NO	10'	NO	-	-	-	-	-	8
DOWNTOWN BUSINESS SUITE 225	1000 SQ FT	30' X 30'	NO	10'	NO	100	66	60	110	35	28

MEETING ROOM CAPACITIES WERE DETERMINED USING 60" ROUNDS OF 10 (ROUNDS CAPACITY), THREE CHAIRS PER 6'X30" TABLE (U-SHAPE CAPACITY) AND THREE CHAIRS PER 6'X18" TABLE (CLASSROOM CAPACITY) ALLOWING FOR MINIMAL AUDIOVISUAL EQUIPMENT.