

FIRST FLOOR

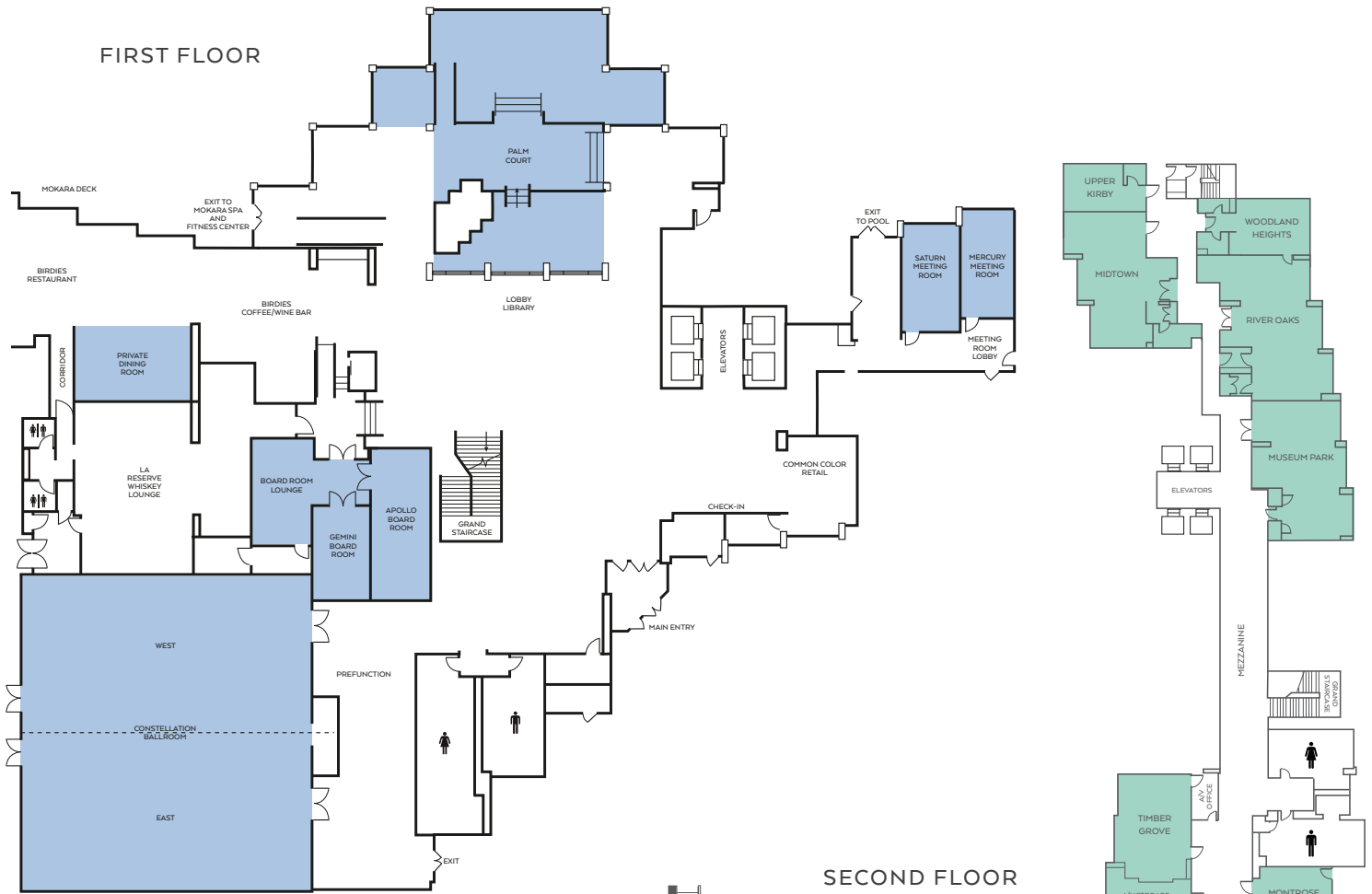

SECOND FLOOR



OMNI HOUSTON HOTEL | MEETING ROOMS

	SQUARE FOOTAGE	DIMENSIONS L X W	CEILING HEIGHT	FLOOR COVERING	PORTABLE WALLS	THEATER	18" CLASSROOM	BANQUET 60"	BANQUET 66"	BANQUET 72"	RECEPTION	U-SHAPE	CONFERENCE
FIRST FLOOR													
CONSTELLATION BALLROOM	5,175	69' X 75'	16'	CARPET	YES	577	357	490	420	432	547	102	96
EAST OR WEST	2,553	69' X 37'	16'	CARPET	YES	277	171	210	180	216	263	68	64
CONSTELLATION PREFUNCTION	1,632	68' X 24'	11'	CARPET	NO	—	—	—	—	—	200	—	—
POOL TERRACE	3,400	50' X 68'	—	CONCRETE	NO	300	—	240	210	252	350	—	—
PALM COURT	4,043	89' X 100'	—	CARPET/ HARDWOOD	NO	—	—	—	220	—	325	—	—
SATURN	290	—	—	CARPET	NO	—	—	—	—	—	—	—	—
MERCURY	275	—	—	CARPET	NO	—	—	—	—	—	—	—	—
APOLLO	505	—	—	CARPET	NO	—	—	—	—	—	—	—	14
GEMINI	305	—	—	CARPET	NO	—	—	—	—	—	—	—	10
SECOND FLOOR													
POST OAK BALLROOM	10,057	113' X 89'	18'	CARPET	YES	1,111	690	820	770	864	1,053	132	124
A, B OR C	1,131	29' X 39'	18'	CARPET	YES	125	75	60	50	60	120	24	26
E, F OR G	1,131	29' X 39'	18'	CARPET	YES	125	75	60	50	60	120	24	26
A-C OR E-G	3,471	39' X 89'	18'	CARPET	YES	377	230	210	210	288	358	60	64
D	3,115	35' X 89'	18'	CARPET	YES	345	210	210	210	216	326	60	64
A-D OR D-G	6,586	74' X 89'	18'	CARPET	YES	711	441	400	350	576	674	85	90
PREFUNCTION A	5,140	—	—	CARPET	NO	—	—	—	—	—	530	—	—
PREFUNCTION B	970	—	—	CARPET	NO	—	—	—	—	—	100	—	—
GREENWAY BALLROOM	3,760	80' X 47'	14'	CARPET	YES	400	220	280	240	288	400	72	76
A	1,880	40' X 47'	14'	CARPET	YES	200	110	140	120	144	200	36	42
B	1,880	40' X 47'	14'	CARPET	YES	200	110	140	120	144	200	36	42
RIVER OAKS	924	42' X 22'	8'2"	CARPET	NO	70	38	60	60	72	70	32	34
MUSEUM PARK	840	42' X 20'	8'2"	CARPET	NO	70	38	60	60	60	70	32	34
WESTBURY	780	30' X 26'	14'	CARPET	NO	50	32	50	50	60	50	24	26
MIDTOWN	720	20' X 36'	8'2"	CARPET	NO	50	28	50	50	60	50	24	26
TIMBER GROVE	638	29' X 22'	10'	CARPET	NO	50	28	50	50	60	50	24	26
HEIGHTS	540	27' X 20'	14'	CARPET	NO	40	26	40	40	40	30	20	22
MEMORIAL	400	20' X 20'	11'	CARPET	NO	30	18	40	30	36	30	18	20
SHADY ACRES	375	15' X 25'	11'	CARPET	NO	—	—	—	—	—	—	—	12
MONTROSE	320	20' X 16'	10'	CARPET	NO	30	18	20	20	24	25	14	16
UPPER KIRBY	324	18' X 18'	10'	CARPET	NO	30	18	20	20	24	25	14	16
WOODLAND HEIGHTS	306	17' X 18'	10'	CARPET	NO	20	16	20	20	24	20	14	16

Meeting room capacities are determined by use of the "Arranger & Comfort Calculator," a standardized meeting room capacity measurement system used by Meeting Professionals International. This chart does not take into consideration those obstructions that can affect the number of persons a room will accommodate, such as columns, exits, airwall closets, staging and audiovisual. 66" banquet capacities are based on 10 per table. 72" banquet capacities are based on 12 per table.