

DISTINCTIVE DETAILS

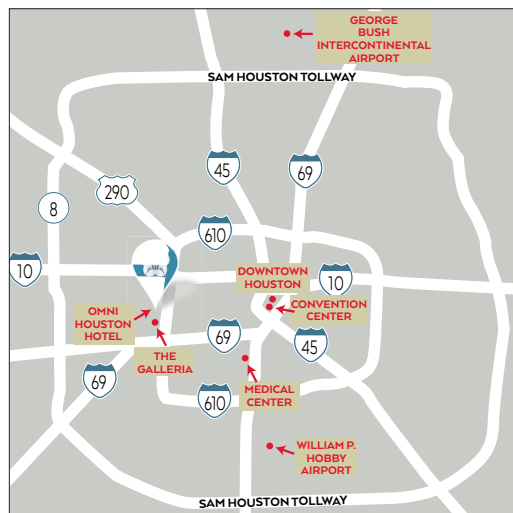

DIRECTIONS

From George Bush Intercontinental Airport: I-45 South to Loop 610 West (becomes 610 South); Exit Woodway, turn right; 2 blocks from Loop 610; Turn left on Riverway.

From William P. Hobby Airport: I-45 North to Loop 610 West (becomes 610 North); Exit Woodway, turn left; 2 blocks from Loop 610; Turn left on Riverway.

FOUR RIVERWAY · HOUSTON, TX 77056 · 713-871-8181 · FAX: 713-871-8116

VISIT OUR WEBSITE AT OMNIHOTELS.COM/HOUSTON · OMNI HOTELS GLOBAL SALES OFFICE NETWORK: 800-788-OMNI (6664)

DESTINATION

Discover Omni Houston Hotel, a luxurious urban oasis situated on impeccably manicured grounds. This AAA Four-Diamond hotel features 378 spacious guest rooms including 33 suites, all with sensational views, and is centrally located in the prestigious Uptown district near The Galleria. The downtown business district is a convenient 10-minute drive from the hotel.

LOCATION

- 5 minutes to Memorial Park and the Memorial Park Golf Course and Driving Range
- 1 mile to the famous Galleria shopping district, featuring specialty shops and exquisite dining
- 7 miles to the heart of downtown Houston and the George R. Brown Convention Center
- 8 miles to NRG Park, including NRG Stadium and NRG Convention Center
- 17 miles/25 minutes from William P. Hobby Airport (HOU)
- 25 miles/35 minutes from George Bush Intercontinental Airport (IAH)

ATTRACTIONS

- 1 mile to The Galleria shopping mall and skating rink
- 1 mile to Highland Village, River Oaks District and Uptown Park shopping, nightlife and dining
- 7 miles to Minute Maid Park, home of the Houston Astros, and Toyota Center, home of the Houston Rockets
- 10 minutes to charming antique shops in the River Oaks/Rice University area
- 10 minutes to Bayou Place, a diverse downtown entertainment complex
- 10 minutes to the Houston Theatre District
- 15 minutes to NRG Stadium, home of the Houston Texans football team
- 20 minutes to Houston’s Museum District, home to 19 museums which are open to the public
- 20 minutes to Houston Zoological Gardens, located at Hermann Park
- 20 minutes to the Texas Medical Center
- 25 minutes to Katy Mills Mall, with more than 200 stores for shopping and dining
- 60 minutes to Galveston Island and Beach
- 50 minutes to San Jacinto Battleground State Historical Park Complex, home to the Battleship Texas and the 570-foot San Jacinto Monument

TEMPERATURE

- Moderate to warm weather attracts visitors to our green escape in the heart of Houston – perfect for nearby golf and shopping
- During the summer months, average daytime temperatures are in the mid-90s with evening lows in the 70s. The rest of the year, high temperatures average in the 70s with lows in the 50s

MONTH	HIGH	LOW
JANUARY	62	42
FEBRUARY	65	45
MARCH	72	53
APRIL	79	61
MAY	84	67
JUNE	90	72
JULY	92	75
AUGUST	92	75
SEPTEMBER	88	71
OCTOBER	81	61
NOVEMBER	72	53
DECEMBER	64	45

TRANSPORTATION

- Two convenient airports for domestic and international travel serving more than 40 million passengers annually
- Complimentary executive shuttle service within three miles of the hotel
- Arrangements can be made for car and limousine service



GUEST SERVICES

GUEST SERVICES

- Express check-in and check-out
- Valet parking (daily parking fee)
- Same-day dry cleaning and laundry
- Postage, package and fax services
- Personalized wake-up calls
- Non-allergenic pillows available
- Get Fit Kit

IN-ROOM AMENITIES

- Complimentary newspaper (upon request)
- Bathrobes
- Hair dryers
- Lighted, magnifying makeup/shaving mirror
- Iron & ironing board
- In-room safe suitable for laptop
- Personal hygiene toiletries

IN-ROOM TECHNOLOGY

- Complimentary Wi-Fi internet with Select Guest membership
- 49" Smart TVs
- Voicemail
- Clock radio with MP3 connection

BUSINESS SERVICES

Most services are available 24 hours, 7 days a week through the Front Desk and include:

- Mail and postage services
- Photocopying
- E-mail
- Printer access
- Faxing

VIP GIFTS

Our staff is well-versed in the selection of special amenities for VIP guests and would be happy to make customized arrangements prior to your guest's arrival. You may also purchase an Omni Hotels & Resorts gift certificate, a luxurious gift for those who appreciate first-class service. For more information, contact the Front Desk.

OMNI SENSATIONAL KIDS PROGRAM

- Complimentary backpack style bag with kid-friendly sensory items presented at check-in.
- Interactive, colorful web pages designed just for Omni Kids at OmniHotels.com.
- Night-time kid's amenity delivered at turndown upon arrival.

SELECT GUEST

As part of our commitment to providing memorable experiences all over the world, Omni Hotels & Resorts is proud to offer our Select Guest® loyalty program and the DISCOVERY loyalty program. Membership is complimentary. Enjoy complimentary perks, earn free nights, experience stay-well amenities and benefit from exclusive offers.

Amenities include:

- Wi-Fi
- Pressing
- Shoeshine
- Bottled water

To learn more, visit OmniHotels.com/Loyalty.

RECREATION

- Two outdoor swimming pools, one heated
- Mokara Spa & Salon with eight treatment rooms, hair and nail salon, sauna, steam room and whirlpools
- Black Swan Nightclub – Enjoy your favorite cocktail and dance the night away to the sounds of our live DJ in this sleek nightclub on Friday and Saturday nights. Hold a private event in this special venue any day of the week.

OFF-SITE RECREATION

- Scenic three-mile walking, jogging and biking paths located in the middle of nearby Tanglewood and Memorial neighborhoods
- Park-like surroundings set on 13 acres of lush greenery
- 18-hole golf course and driving range at nearby Memorial Park
- 60 minutes to Galveston Island and Beach

FITNESS CENTER

- Complimentary full-service private recreation center
- Stationary bicycles (Precor + Pelaton)
- Treadmills
- Elliptical machines
- Free weights
- In-room fitness kits available

ACCOMMODATIONS

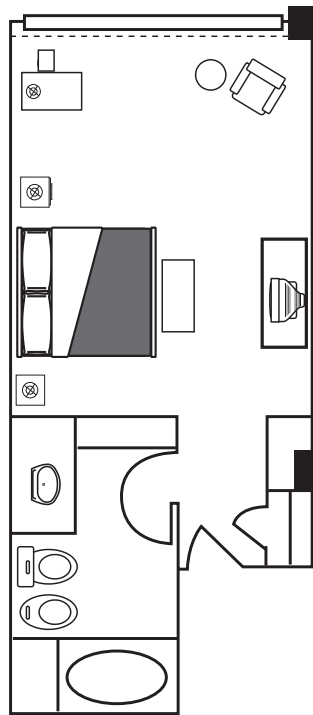

KING ROOM

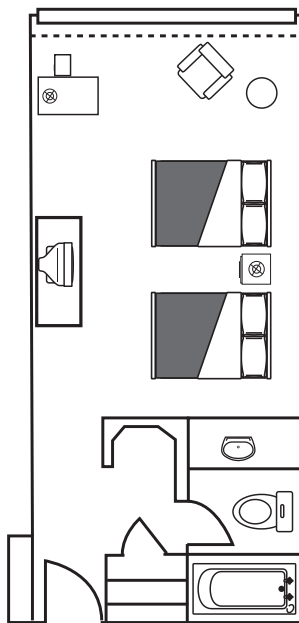

QUEEN/QUEEN ROOM

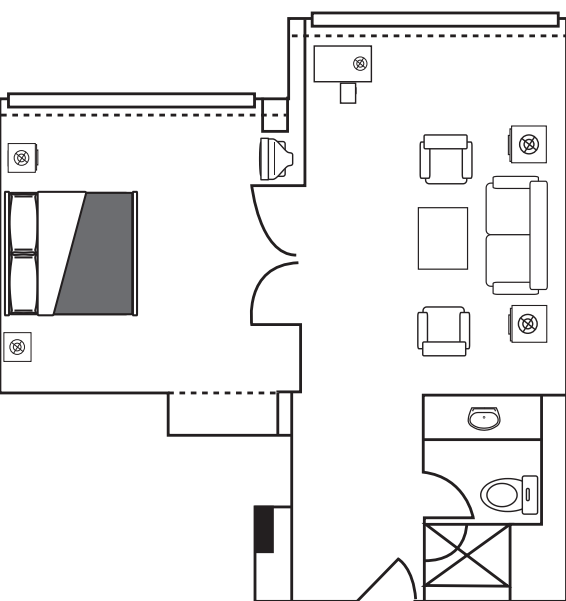

GALLERIA SUITE

GUEST ROOMS

Our 378 guest rooms come with a king-size bed or two queen beds, and a sitting area that overlooks the city or the hotel's pools and gardens. Relax in front of our 49" Smart TVs with Google Chromecast. Each guest room has an executive-style desk and conveniences of home.

SUITES

We offer 23 spacious Galleria Suites, featuring a king bed and two French doors separating the bedroom area from the sitting area. A large pull-out sleeper sofa, side chairs and a coffee table decorate the well-appointed sitting area. The bath area is complemented with a marble vanity and marble floors, a large oval garden tub and shower, and an assortment of cosmetic toiletries.

GUEST ROOMS

ROOM CATEGORY	NUMBER	SQUARE FEET
Deluxe King	84	380
Deluxe Queen/Queen	66	380
Premier King	104	380
Premier Queen/Queen	79	380
Accessible Rooms	12	380
Executive Suite	5	605
Galleria Suite	23	554
Parlor Suite	4	811
Presidential Suite	1	1,472

All guest rooms are equipped with AM/FM clock radio, 49" Smart TVs with Google Chromecast, Keurig coffee maker, iron, full-size ironing board, terry cloth bathrobe, easy chair, hair dryer, voicemail, and a fully-stocked refreshment center.

FOOD & BEVERAGE

BIRDIES CAFE & BAR

Inspired by former First Lady Lady Bird Johnson for her impact on the preservation of wildflowers throughout the state. Taking its design inspiration from our surrounding ground's lavish greenery, guests will enjoy the outdoor landscape views through floor-to-ceiling windows. Birdies Cafe & Bar is open daily for breakfast, lunch and dinner. With a grab & go coffee bar that turns wine lounge in the evening.

RESTAURANT: 6:30 A.M. - 2:00 P.M. DAILY

BREAKFAST: 6:30 A.M. - 11:00 A.M. DAILY

ALL DAY MENU: 11:00 A.M. - 2:00 P.M.

COFFEE BAR: 6:00 A.M. - 2:00 P.M. DAILY

BAR & LOUNGE: 2:00 P.M. - 10:00 P.M. DAILY

LA RESERVE WHISKEY LOUNGE

La Reserve Whiskey Lounge pays homage to Houston's history with design inspiration drawn from an authentic local aesthetic that includes leathers, bronze and cowhide providing a new take on a "modern Texas." It features local premium blends, craft cocktails and Texas tapas, making it an ideal location to relax and unwind following a busy day of meetings.

SUNDAY - THURSDAY: 5:00 P.M. - 12:00 A.M.

FRIDAY & SATURDAY: 5:00 P.M. - 1:00 A.M.

SPA & SALON

MOKARA SPA & SALON

Omni's award-winning signature spa allows guests to spoil their senses in our eight treatment rooms, full-service salon, sauna, steam room, whirlpools and fitness center*. The spa and salon are available for groups or specialized individual treatments.

OPEN SEVEN DAYS A WEEK:

MONDAY - FRIDAY: 9:00 A.M. - 8:00 P.M.

SATURDAY: 8:00 A.M. - 8:00 P.M.

SUNDAY: 9:00 A.M. - 6:00 P.M.

*Subject to availability

POOL BAR & GRILL

Relax poolside and enjoy casual food and beverage service. Private cabanas are also available. Seasonally.

COMMONCOLOR

This fine retailer features high end gifts, sundries, snacks and essentials.

OPEN: 8:00 A.M. - 8:00 P.M. DAILY

BLACK SWAN NIGHTCLUB

This chic, urban nightclub is a local favorite where you can enjoy cocktails and dance the night away to the contemporary sounds played by a live DJ.

FRIDAY & SATURDAY: 8:00 P.M. - 2:00 A.M.

IN ROOM DINING

For your convenience, 24-hour in-room dining is available if you choose to enjoy delicious cuisine in the privacy of your guest room. Our chef is delighted to accommodate your special dining needs.

CONFERENCE SPECIFICATIONS

TECHNICAL ASSISTANCE

Our on-site audio/visual team is available to consult and assist with all technical aspects of your function, including audio/visual, staging and lighting equipment rental and operational support. Appointments are suggested to discuss specific lighting, electrical or other technical considerations.

MUSIC AND ENTERTAINMENT

- Pre-programmed music is offered in all public space and meeting rooms. Referrals to live music and entertainment to further enhance your event are available upon request.
- The Landing offers the perfect setting for group meals and receptions
- Dancing and music in the Black Swan Nightclub

ELECTRICAL CONSIDERATIONS

Standard electrical outlets are located in all guest and meeting rooms.

High-speed internet access is available in all meeting rooms. Additional power, data and phone lines can be custom installed upon request. Our engineering team is on-site to assist and consult with you on your special electrical or structural needs.

SHIPPING AND RECEIVING

Arrangements for the delivery and receipt of large or bulk items should be finalized with your sales/conference service manager at the hotel. All packages should be sent to the attention of your group's name and include the conference planner's name. Hotel storage is limited and may not be available for extended periods of time.

RECEIVING DOCKS

Our hotel is equipped with four freight elevators and a loading dock for your convenience. Your conference planner will assist you in planning the delivery and setup of your meeting and presentation materials. For meetings with extensive staging and loading, we suggest that your delivery personnel visit with the security office prior to your event to help ensure a timely setup.

PARKING

- Valet parking available (fee)
- Covered self-parking (fee)

MEETINGS AND EVENT SPACE SPECIFICATIONS

FACILITIES

- 40,000 square feet of flexible function space
- 26 reception and conference rooms with three boardrooms for small breakouts or meetings
- Three large, elegant ballrooms, including the 10,057 square-foot Post Oak Ballroom

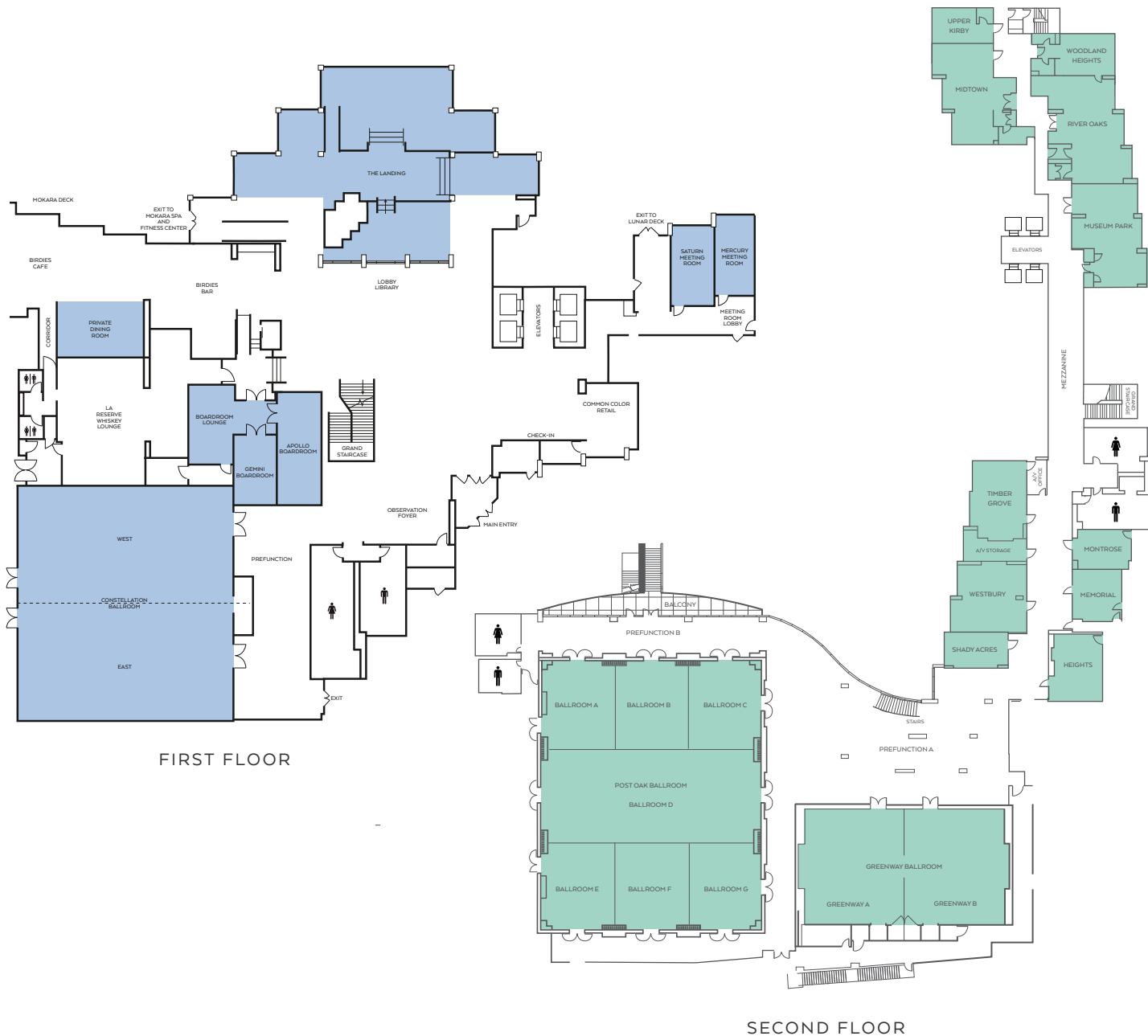

FIRST FLOOR

SECOND FLOOR

MEETINGS AND EVENT SPACE SPECIFICATIONS

	SQUARE FOOTAGE	DIMENSIONS L X W	CEILING HEIGHT	FLOOR COVERING	PORTABLE WALLS	THEATER	18" CLASSROOM	BANQUET 60"	BANQUET 66"	BANQUET 72"	RECEPTION	U-SHAPE	CONFERENCE
FIRST FLOOR													
CONSTELLATION BALLROOM	5,175	69' X 75'	16'	CARPET	YES	577	357	490	420	432	547	102	96
EAST OR WEST	2,553	69' X 37'	16'	CARPET	YES	277	171	210	180	216	263	68	64
CONSTELLATION PREFUNCTION	1,632	68' X 24'	11'	CARPET	NO	—	—	—	—	—	200	—	—
POOL TERRACE	3,400	50' X 68'	—	CONCRETE	NO	300	—	240	210	252	350	—	—
THE LANDING	4,043	89' X 100'	—	CARPET/ HARDWOOD	NO	—	—	—	220	—	325	—	—
SATURN	290	—	—	CARPET	NO	—	—	—	—	—	—	—	—
MERCURY	275	—	—	CARPET	NO	—	—	—	—	—	—	—	—
APOLLO	505	—	—	CARPET	NO	—	—	—	—	—	—	—	14
GEMINI	305	—	—	CARPET	NO	—	—	—	—	—	—	—	10
SECOND FLOOR													
POST OAK BALLROOM	10,057	113' X 89'	18'	CARPET	YES	1,111	690	820	770	864	1,053	132	124
A, B OR C	1,131	29' X 39'	18'	CARPET	YES	125	75	60	50	60	120	24	26
E, F OR G	1,131	29' X 39'	18'	CARPET	YES	125	75	60	50	60	120	24	26
A-C OR E-G	3,471	39' X 89'	18'	CARPET	YES	377	230	210	210	288	358	60	64
D	3,115	35' X 89'	18'	CARPET	YES	345	210	210	210	216	326	60	64
A-D OR D-G	6,586	74' X 89'	18'	CARPET	YES	711	441	400	350	576	674	85	90
PREFUNCTION A	5,140	—	—	CARPET	NO	—	—	—	—	—	530	—	—
PREFUNCTION B	970	—	—	CARPET	NO	—	—	—	—	—	100	—	—
GREENWAY BALLROOM	3,760	80' X 47'	14'	CARPET	YES	400	220	280	240	288	400	72	76
A	1,880	40' X 47'	14'	CARPET	YES	200	110	140	120	144	200	36	42
B	1,880	40' X 47'	14'	CARPET	YES	200	110	140	120	144	200	36	42
RIVER OAKS	924	42' X 22'	8'2"	CARPET	NO	70	38	60	60	72	70	32	34
MUSEUM PARK	840	42' X 20'	8'2"	CARPET	NO	70	38	60	60	60	70	32	34
WESTBURY	780	30' X 26'	14'	CARPET	NO	50	32	50	50	60	50	24	26
MIDTOWN	720	20' X 36'	8'2"	CARPET	NO	50	28	50	50	60	50	24	26
TIMBER GROVE	638	29' X 22'	10'	CARPET	NO	50	28	50	50	60	50	24	26
HEIGHTS	540	27' X 20'	14'	CARPET	NO	40	26	40	40	40	30	20	22
MEMORIAL	400	20' X 30'	11'	CARPET	NO	30	18	40	30	36	30	18	20
SHADY ACRES	375	15' X 25'	11'	CARPET	NO	—	—	—	—	—	—	—	12
MONTROSE	320	20' X 16'	10'	CARPET	NO	30	18	20	20	24	25	14	16
UPPER KIRBY	324	18' X 18'	10'	CARPET	NO	30	18	20	20	24	25	14	16
WOODLAND HEIGHTS	306	17' X 18'	10'	CARPET	NO	20	16	20	20	24	20	14	16

Meeting room capacities are determined by use of the "Arranger & Comfort Calculator," a standardized meeting room capacity measurement system used by Meeting Professionals International. This chart does not take into consideration those obstructions that can affect the number of persons a room will accommodate, such as columns, exits, airwall closets, staging and audiovisual. 66" banquet capacities are based on 10 per table. 72" banquet capacities are based on 12 per table.