

# HOTEL OMNI MONT-ROYAL MEETING SPACE

## FIRST FLOOR

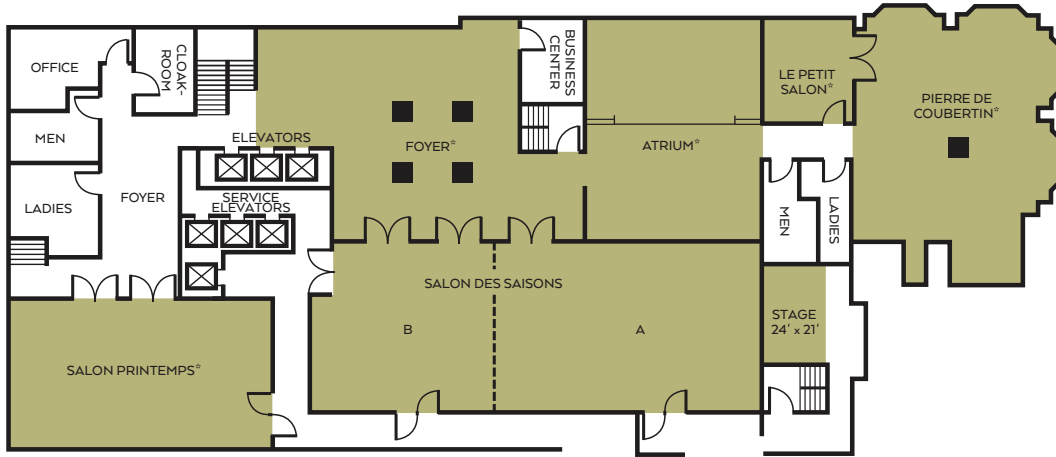

## SECOND FLOOR



\* Natural Light

## LOWER LEVEL

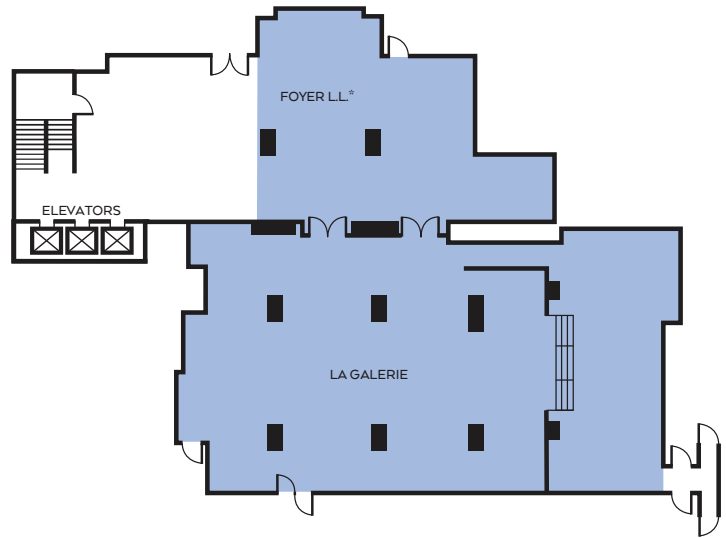

# HOTEL OMNI MONT-ROYAL MEETING ROOM CAPACITY

	SURFACE		CEILING HEIGHT		U-SHAPE		HOLLOW SQUARE	THEATRE	CONFERENCE	CLASSROOM		ROUNDS 8-10 PERS	1/2 ROUNDS/ CRESCENT ROUNDS 4-5 PERS	EXHIBITS			RECEPTION
	METERS	SQUARE FEET	METERS	FEET	2 PER/6'	3 PER/6'				2 PER/6'	2 PER/6'			6' x 6'	8' x 8'	10' x 10'	
<b>FIRST FLOOR</b>																	
SAISONS A&B	410	4,410	4.27	14	68	97	114	480	80	192	288	320/400	160/200	27	32	22	484
SAISON A	242	2,610	4.27	14	38	63	80	300	40	108	130	160/200	80/100	19	17	10	284
SAISON B	163	1,755	4.27	14	30	45	60	180	34	48	72	188/160	94/80	8	9	16	189
PRINTEMPS	185	1,972	3	10	36	54	65	180	48	72	110	144/180	72/90	13	10	6	211
PIERRE DE COUBERTIN	251	2,700	4.27	14	38	44	56	180	40	100	144	200/250	100/125	19	17	11	316
PETIT SALON	37	400	4.27	14	10	15	20	20	14	12	18	24/30	15	-	1	1	25
ATRIUM	152	1,638	7.01	23	-	-	-	-	-	-	-	-	-	10	6	4	174
FOYER 1	249	2,680	2.77	9	-	-	-	-	-	-	-	-	-	-	-	-	285
<b>SECOND FLOOR</b>																	
ÉTÉ	177	1,904	3.07	10	36	54	65	180	48	72	110	136/170	68/85	15	10	6	205
AUTOMNE	69	738	3.07	10	20	26	30	55	25	20	28	40/50	20/25	-	2	-	79
HIVER	37	396	3.07	10	10	15	20	20	18	12	18	24/30	12/15	-	-	-	-
SHERBROOKE	22	241	3.07	10	-	-	-	-	10	-	-	-	-	1	-	-	-
FOYER 2	107	1,152	3.07	10	-	-	-	-	-	-	-	-	-	-	-	-	76
<b>LOWER LEVEL</b>																	
LA GALERIE	316	3,400	2.74	9	34	51	54	144	48	48	72	192/240	96/120	14	14	10	229
FOYER LL	184	1,981	2.48	8.15	-	-	-	-	-	-	-	-	-	14	14	14	134