

# OMNI VIKING LAKES HOTEL MEETING SPACE

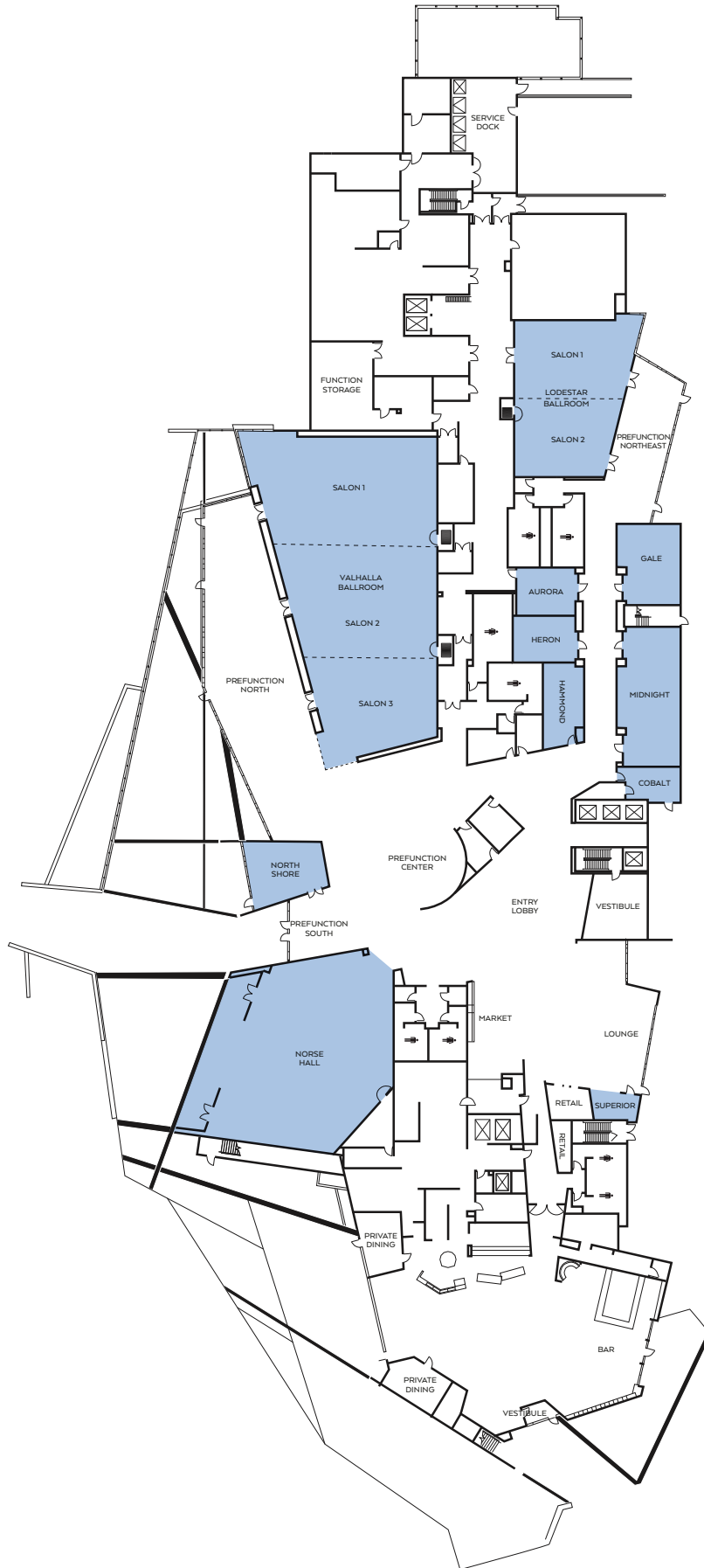

## OMNI VIKING LAKES HOTEL MEETING ROOM CAPACITY

	DIMENSIONS	SQUARE FOOTAGE	THEATER	2 PER 6' CLASSROOM	3 PER 6' CLASSROOM	72" ROUNDS OF 12	60" ROUNDS OF 10	RECEPTION	HOLLOW SQUARE 3 PER 6'	CONFERENCE 3 PER 6'	U-SHAPE 3 PER 6'
PREFUNCTION NORTH	N/A	N/A	N/A	N/A	N/A	N/A	N/A	N/A	N/A	N/A	N/A
VALHALLA BALLROOM	44/78' X 118/136'	7,511	624	284	420	492	410	800	N/A	N/A	N/A
SALON 1	42' X 64/78'	3,118	220	72	108	168	160	325	66	48	60
SALON 2	43' X 53/64'	2,604	188	56	141	144	130	275	54	42	48
SALON 3	30/42' X 44/53'	1,789	110	44	72	72	90	125	42	30	39
PREFUNCTION NORTHEAST	N/A	N/A	N/A	N/A	N/A	N/A	N/A	N/A	N/A	N/A	N/A
LODESTAR BALLROOM	36/50' X 65'	2,643	154	72	108	120	130	275	54	42	51
SALON 1	33' X 41/50'	1,563	90	36	57	72	60	150	36	30	33
SALON 2	27' X 35/41'	1,081	50	25	35	24	40	100	30	24	24
COBALT	12/13' X 17'	232	N/A	N/A	N/A	N/A	N/A	12	N/A	6	N/A
SUPERIOR	8/11' X 16/19'	181	N/A	N/A	N/A	N/A	N/A	N/A	N/A	6	N/A
NORTH SHORE	15/25' X 31/36'	619	22	10	14	12	20	45	12	18	12
MIDNIGHT	21' X 52'	1,214	41	24	32	48	40	90	24	32	30
GALE	21/24' X 30'	708	30	15	20	24	30	70	18	22	15
HERON	18' X 24'	447	16	6	9	12	10	35	12	16	9
AURORA	18' X 22'	430	16	6	9	12	10	35	12	12	9
HAMMOND	12' X 33'	486	20	6	9	N/A	20	35	N/A	16	N/A
NORSE HALL	N/A	4,403	320	144	220	276	240	500	78	66	57

Capacities based on industry averages, and do not take into account state or local codes or occupancy limits.

