

## OMNI TUCSON NATIONAL RESORT MEETING SPACE

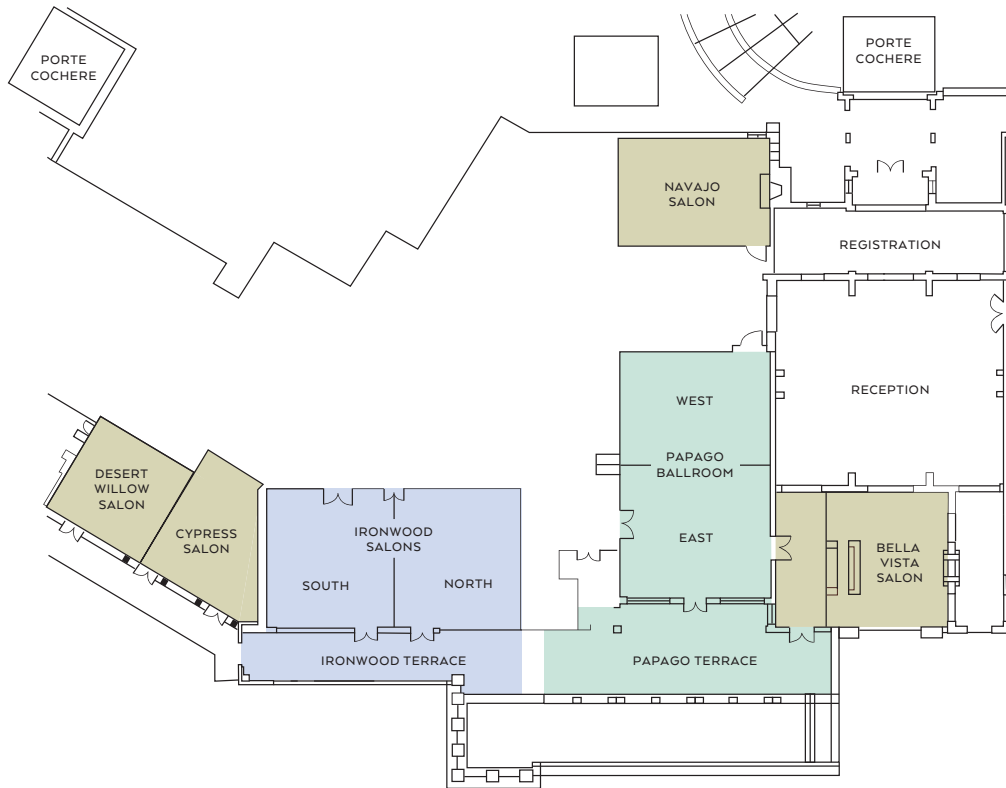

## OMNI TUCSON NATIONAL RESORT MEETING ROOM CAPACITY

	SQUARE FOOTAGE	DIMENSIONS	CEILING HEIGHT	PORTABLE WALLS	THEATER	CLASSROOM 18"	CLASSROOM 30"	BANQUET 60"	RECEPTION	CONFERENCE	HOLLOW SQUARE
<b>PAPAGO</b>											
PAPAGO BALLROOM	2,870	70' x 41'	12'6"	YES	290	198	100	240	350	18	80
PAPAGO EAST	1,558	38' x 41'	12'6"	YES	155	70	45	100	130	9	42
PAPAGO WEST	1,312	32' x 41'	12'6"	YES	130	52	25	90	110	8	36
PAPAGO TERRACE	2,000	—	12'6"	—	—	—	—	140	190	—	—
<b>IRONWOOD</b>											
IRONWOOD SALON	2,652	68' x 39'	12'6"	YES	225	160	120	220	300	16	72
IRONWOOD SOUTH	1,326	34' x 39'	12'6"	YES	90	50	40	90	110	8	36
IRONWOOD NORTH	1,326	34' x 39'	12'6"	YES	90	50	40	90	110	8	36
IRONWOOD TERRACE	1,000	—	12'6"	—	—	90	72	60	120	8	—
<b>INDIVIDUAL SPACES</b>											
CYPRESS SALON	1,054	32' x 31'	12'6"	—	70	40	25	50	90	8	25
DESERT WILLOW SALON	783	27' x 29'	12'6"	—	50	36	27	50	70	6	20
NAVAJO SALON	1,270	41' x 31'	12'6"	—	110	50	36	80	110	7	34
BELLA VISTA SALON	1,800	49'6" x 60'	12'6"	—	130	57	48	140	145	12	45
<b>OUTDOOR SPACES</b>											
MESQUITE GULCH	5,400	—	—	—	—	—	—	360	450	—	—
SWEETWATER TERRACE	1,500	—	—	—	—	—	—	130	168	—	—
NORVILLE LAWN	6,000	—	—	—	—	—	—	400	500	—	—

Meeting room capacities are determined by the use of the "Arranger & Comfort Calculator," a standardized meeting room capacity measurement system used by Meeting Professionals International. 60" banquet capacities are based on 10 persons per table.\*Available evenings only.